

# A QUICK GUIDE TO THE WILLIAM MORRIS WINDOWS IN BRADFORD CATHEDRAL



## I. The East Window (Lady Chapel)

In the early 1860's members of the congregation were invited to make contributions towards a restoration scheme and it was probably at this point that Mrs. Tolson decided to present this window in memory of her late husband. On the suggestion of one of her husband's old friends, John Aldam Heaton the commission was given to the recently-established workshop of Morris, Marshall, Faulkner & Co. of London.

It was originally installed in the East End of the then Parish church in 1863 as one complete window. It was moved to its present location during the extension work in the 1960's and split into three separate windows as seen today.

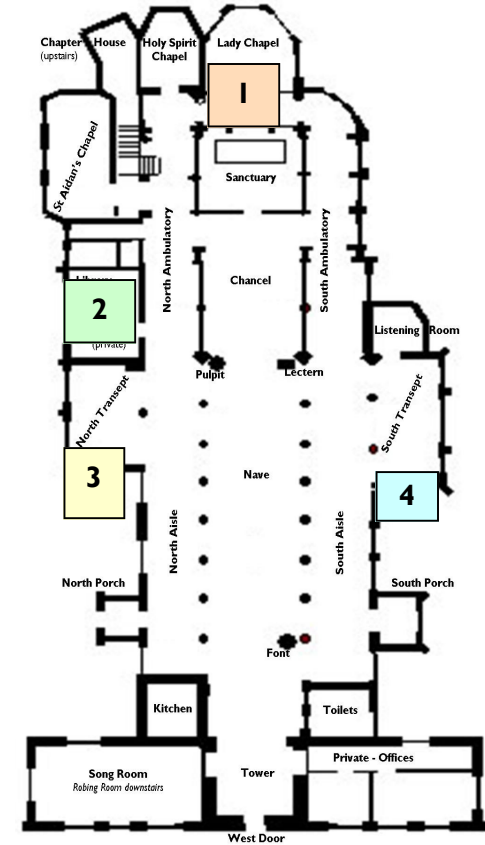

Top Tier: Women	<b>Anna the Prophetess</b> Stars PPM	<b>Elisabeth a and son</b> FMB
Third Tier: Evangelists	<b>John the Baptist</b> Bowl and banner WM	<b>Matthew</b> Winged man, blessing FMB
Second Tier: Patriarchs	<b>Abraham</b> Knife and small son, Isaac FMB	<b>Old Isaac</b> Blessing and wooden vessel FMB
Lowest Tier: Prophets	<b>Moses</b> Tablets of stone marked 1-X; 2 horns PPM	<b>Isaiah</b> Scroll: 'unto us a child is born, unto us a son is given' WM

<b>Virgin Mary</b> Book, Madonna lily, long fair hair, halo EBJ	Christ in Majesty DGR	<b>Mary Magdalene</b> Long hair, jar of spikenard DGR
<b>Mark</b> Winged lion and book scroll EBJ		<b>Luke</b> Winged ox WM
<b>Jacob</b> Pan and smoke, pouch DGR	St Peter PPM	<b>David</b> Crown, chain mail, no shoes, dove, harp EBJ
<b>Jeremiah</b> Scroll 'Thou wilt return Israel' WM	Agnus Dei PW	<b>Ezekiel</b> Prayer and hood DGR

<b>Martha</b> Copper pan, wooden spoon and leather bottle DGR	<b>Mary of Bethany</b> Long fair hair, book, spray of leaves WM
<b>John</b> Eagle FMB	<b>Paul</b> Scroll and seal, broad sword FMB
<b>Solomon</b> Crown, blessing and sceptre PPM	<b>Joseph of Nazareth</b> Bare feet, staff, cloak WM
<b>Daniel</b> Mene mene tekel upharsin Daniel 5:25-28) DGR	<b>Elijah</b> Raven and bread WM

## Artists

- WM William Morris
- FMB Ford Madox Brown
- EBJ Edward Burne Jones
- DGR Dante Gabriel Rossetti
- PPM Peter Paul Marshall
- PW Philip Webb



Windows 2, 3, & 4 formed the original South Chancel window of 1864. During the extension work of the 1960's it was removed and then re-sited in 1992 in three locations: the west walls of the transepts, and the illuminated window in the North Ambulatory.

## 2. North Ambulatory

The central figure of the original window, Salvator Mundi, was designed by architect Albert Moore and the angels from the tracery by William Morris. The Pelican feeding its young was designed by Phillip Webb.



## 3. North Transept

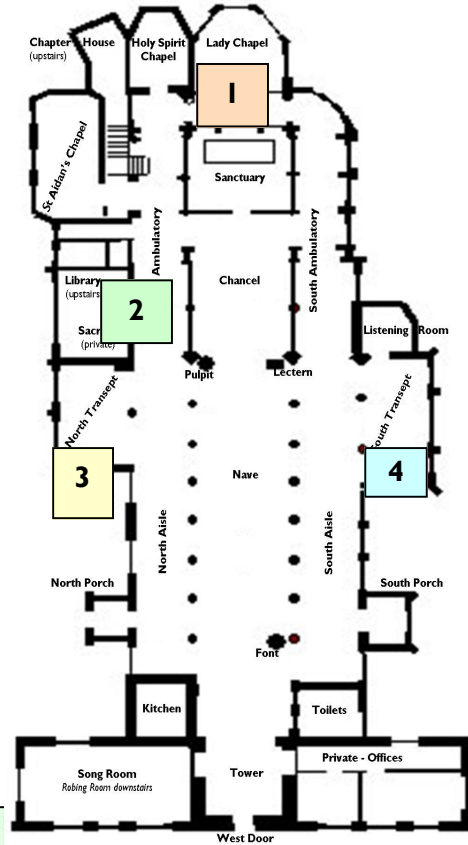

## 4. South Transept



St. Barnabas	St Jude	St Cyprian	St Alban
holding a Book	holding a staff	In Episcopal dress	holding a sword
William Morris	Edward Burne-Jones	William Morris	Edward Burne-Jones



St. Stephen	St Andrew	St James the Great	St James the Less
holding stones	Holding a X shaped cross	Holding a book	Holding a staff
Edward Burne-Jones	Ford Madox Bown	Edward Burne-Jones	Edward Burne-Jones