

Getting to Bradford Cathedral (inc. the Chapter House)

Please see below for some **frequently asked questions** about visiting Bradford Cathedral for an event. Want to know more, or that something should be added below? E-mail us on events@bradfordcathedral.org

Getting here

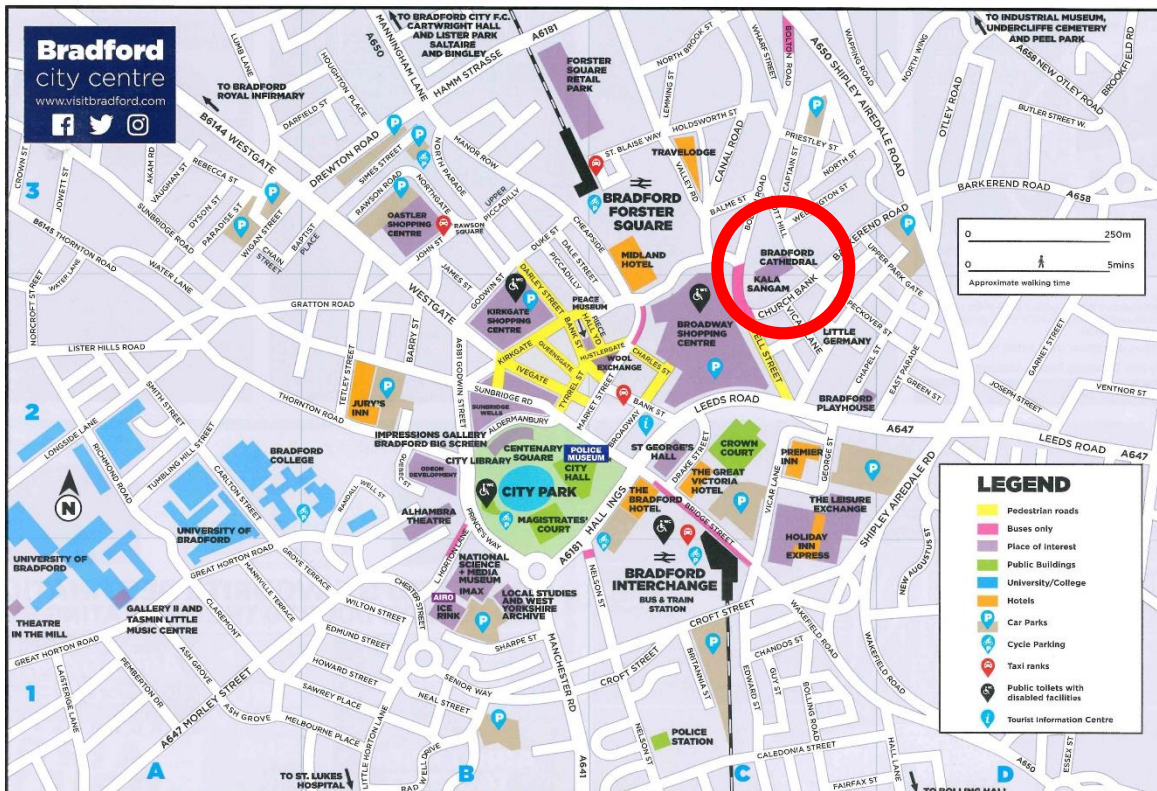

Bradford Cathedral is located on Stott Hill, Bradford, BD1 4EH.

Bradford Cathedral is a five-minute walk from **Bradford Forster Square** train station and a ten-minute walk from **Bradford Interchange** train station. Both stations are serviced by taxis. From Bradford Forster Square, please head out of the station towards the Midland Hotel (up the sloping road) and then to The Broadway, and pick up the instructions further down. From the Bradford Interchange, please follow the signs to The Broadway and then head through the shopping centre to Marks and Spencer, and come out the entrance there. From here, please pick up the instructions further down.

1 Stott Hill, Bradford, BD1 4EH
01274 77 77 20 | info@bradfordcathedral.org

bradfordcathedral.org.uk

@BfdCathedral

You can also reach the Cathedral by bus from the **Bradford Interchange** bus station*, as well as other stops around the city. We recommend using <https://moovitapp.com/> for the most up-to-date travel arrangements.

*The bus station is currently out of service. Please see <https://www.wymetro.com/plan-a-journey/travel-news/bus-travel-alerts/bradford-interchange-closed/> for updates.

For those travelling by **car**, you can get to the Cathedral grounds by following the signs for the Cathedral when travelling on the A650 Shipley / Airedale Road. We have limited parking on site, and this usually has to be booked in advance with us. We recommend parking at the Broadway Bradford shopping centre, which can be accessed off Leeds Road, but there are alternative car parks in the area. For more information on availability and prices, please search online or visit a site such as www.parkopedia.com. **Please note that works are taking place around the city that may affect journey in.**

To find Bradford Cathedral from the Broadway Bradford, use the lifts of stairs to get onto the ground floor and head towards Marks and Spencer. From there, leave by the doors and you should see a statue in front of you. From here, either enter via the State Gate entrance straight ahead and to your left, or head up Church Bank to the right to find the other entrances. **For late evening events, only certain entrances may be open. Please check with us if you are unsure.**

For those travelling by **bike**, we have a limited number of lockable cycle racks, located down the steps by the North Door.

We also have a dedicated drop-off point and parking space for **minibuses and coaches**. For more information, please speak to us.

For more information and maps, please visit <https://bradfordcathedral.org.uk/plan-your-visit>

Arriving on Site

There are three entrances to Bradford Cathedral:

- The State Gate – this is located opposite Marks and Spencer at the Broadway Bradford
- Church Bank – this is located about 1/3 of the way up Church Bank
- Stott Hill – this is located on Stott Hill, opposite Cathedral Halls, and there is both a pedestrian entrance and a car entrance. This is an accessible step-free entrance*

**Bradford Cathedral is an ancient site, and whilst many areas are accessible, certain areas are uneven. If you need any support when visiting the Cathedral, please speak to a member of the team.*

Not all entrances are open all the time. You will be advised when booking about the best entrance to use, or where to meet, but if you have any issues getting into the Cathedral please call 01274 77 77 20 or use the buzzer by the Stott Hill gate – pressing the ‘Cathedral Office’ button.



BRADFORD CATHEDRAL

1 Stott Hill, Bradford, BD1 4EH
01274 77 77 20 | info@bradfordcathedral.org

bradfordcathedral.org.uk     @BfdCathedral

MUSEUMS + HERITAGE AWARDS SHORTLISTEE 2022

AWARD FOR BEST VISIT 2022 FINALIST

AWARD FOR BEST VISIT AWARDS 2023 FINALIST

Quality Badge awarded by Council for Learning Outside the Classroom

WHITE ROSE AWARDS 2020 GOLD

The Chapter House is located at the East End of the Cathedral.

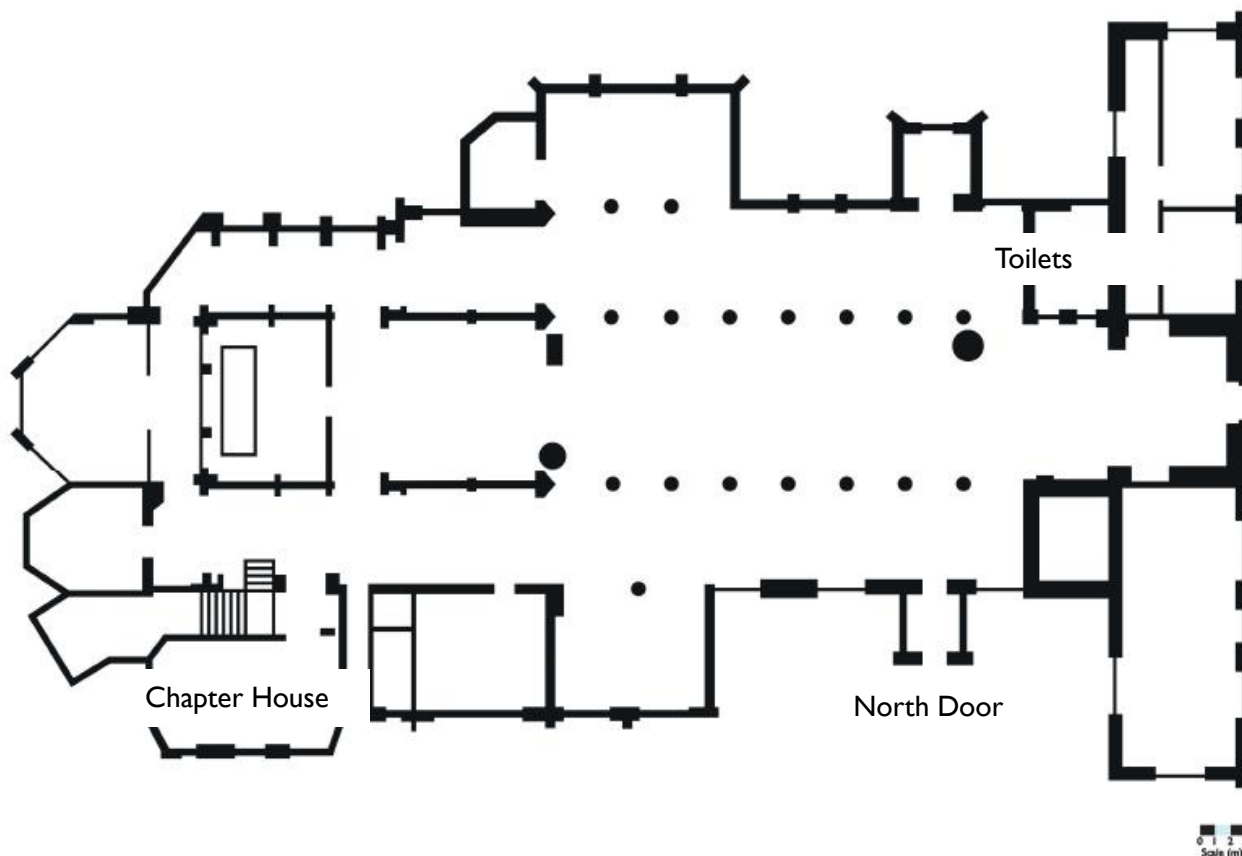

Frequently asked questions

Chapter House: What furniture is included in the room?

There are typically eight tables and around 20 chairs, which can be laid out in a variety of formats depending on your requirements (please see the booking form). There is also a small plasma screen with a HDMI input.

Chapter House: Where can I find the toilet?

There is one toilet located to the left of the Chapter House as you leave the room, alongside a small kitchen.

Cathedral: Where can I find the toilets?

The toilets are located at the West End of the building, next to the shop.

What do I need to do in a medical emergency?

Please see a member of the team who will be happy to help. There is a first aid kit in the Chapter House kitchen, and there is a list of current first aiders with contact numbers by the phone. For the Cathedral the first aid kit is located opposite the Cathedral office, at the tower end, where you will also find a defibrillator.

You can also make contact with a member of staff using the telephone located in the corner of the room; there is a list of names on the menu in the bottom right-hand corner.

3

BRADFORD CATHEDRAL

1 Stott Hill, Bradford, BD1 4EH
01274 77 77 20 | info@bradfordcathedral.org

bradfordcathedral.org.uk [f](https://www.facebook.com/BfdCathedral) [X](https://www.x.com/BfdCathedral) [@BfdCathedral](https://www.instagram.com/BfdCathedral) [y](https://www.youtube.com/BfdCathedral)

How do I connect to the wi-fi?

We offer free wi-fi to those in the Cathedral. Please connect to 'Bradford Cathedral Guest', using the password 'bc102018'.

Where can I eat in the area?

There is a café located on Church Bank. There are also a range of restaurants in and around the Broadway Bradford, as well as in the city centre of Bradford, all within a ten-minute walk of the Cathedral.

How can I find out more about Bradford Cathedral?

Please visit our website at bradfordcathedral.org, find us on social media, e-mail info@bradfordcathedral.org or call us during office hours (Mon – Fri, 9am – 2:45pm) on 01274 77 77 20.

Where do we gather in the event of a fire alarm?

Please head to the top of the State Gate steps, which are to the right as you leave the de Lacy Centre, down the road within the Cathedral grounds.

Last updated: Thursday 7th March 2024



1 Stott Hill, Bradford, BD1 4EH
01274 77 77 20 | info@bradfordcathedral.org

bradfordcathedral.org.uk     @BfdCathedral



